

3.0

# SIGN SUSPENSION SYSTEM

**ALEMTEK**

Alemtek, founded in 2000, is a multigenerational family company dedicated to providing innovative suspension systems through a unique partnership. Working with our team is a creative process that enables new ideas and offers you support in developing new solutions.

With over 25 years in the industry, partnering with us is simple, and our suspension solutions are easy-to-use, durable, and designed for minimal impact.

Note that the examples shown are only some parts of our full product range. Visit our website or contact us directly for more information and customization.

Our service is at your disposal.

## ALEMTEK





## Attachment

A fixed point attached to ceilings, walls, floors, or products by screws to enable wire suspension. Most often an attachment to the ceiling is used.

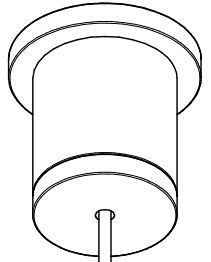

## Wire

A steel wire made for high performance together with a gripper. The wire ending is shaped to suit your installation and can be fastened to an attachment or your product.

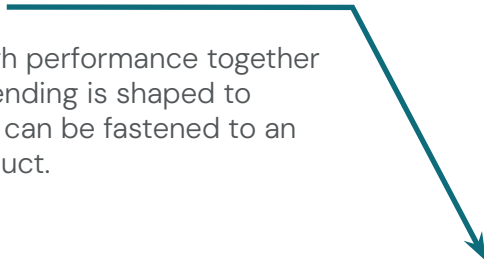

## Gripper

Compact designed grippers allow swift installation and instant adjustment. Alemtek has many different models to choose from, depending on your area of use and weight capacities. Always match the gripper with the chosen wire diameter.

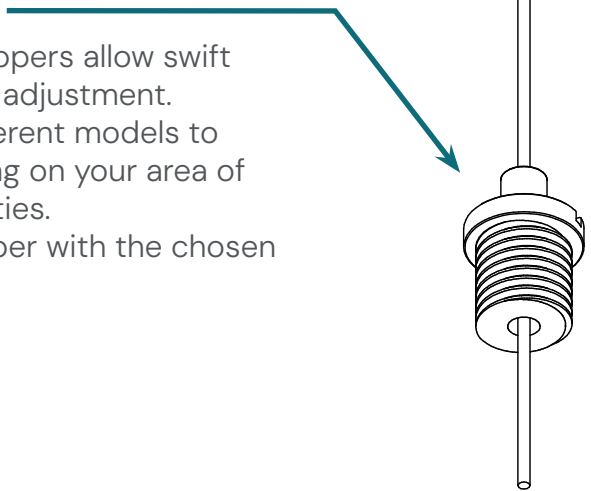

# How to use grippers

**A** Insert the wire through the gripper pin, unless specified otherwise.



**B** Slide the gripper upward to adjust its position. Once you release it, the gripper will automatically lock onto the wire.

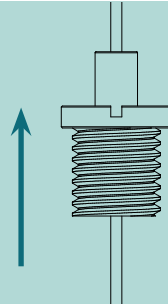

**C** To unlock, press down the gripper pin. This allows the gripper to slide freely up and down the wire. To lock it in place again, simply release the gripper pin.

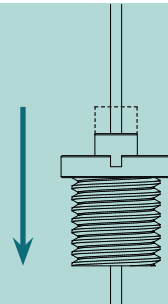

## Attachment

Choose attachment based on the type of ceiling and desired style.

32SD4L30J



32SM5LX



32SM5L5



## Wire

Choose wire based on the suspended product's weight and wire endings based on gripper and attachment.

T95

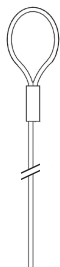

T7



T2



## Gripper

Choose gripper based on how you want to suspend your product.

9-38E



9-39J

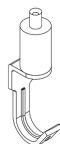

9-39UPDNW

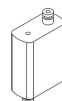

9-39U



## Accessories

Some products have extra accessories depending on how the product is going to be used.

712MM5L8



796D1-5



726MIOPI



For measurements and more information about the products please visit [www.alemtek.com](http://www.alemtek.com)

412M13M6BL20

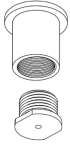

412MM12M5BL9

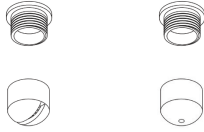

412M8M6BL20U

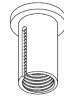

52-API

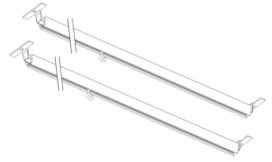

411MM13BL12

411M12BL14U

411M12BL14H

T3



TJ



F



9-38M5



9-33M10



9-13H



9-4401



7801



7802



For measurements and more information about the products please visit [www.alemtek.com](http://www.alemtek.com)

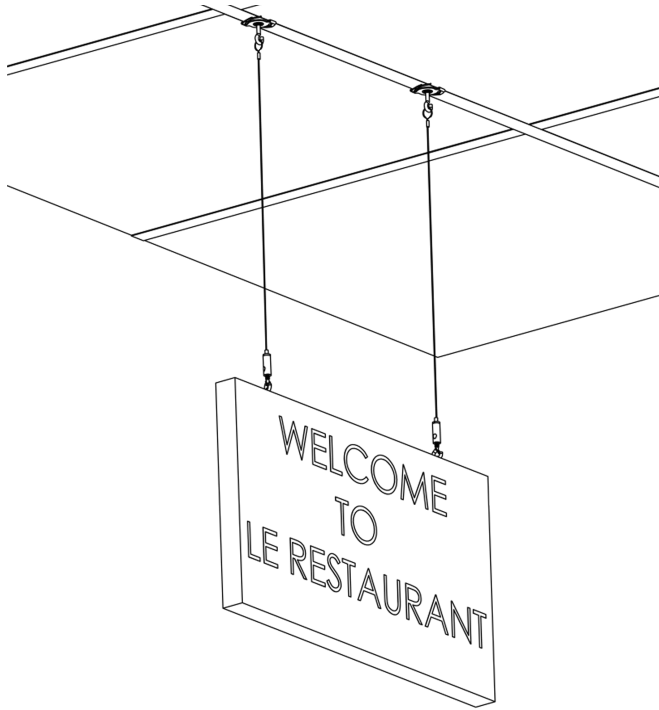

## Attachment

2 x 32SD4L30J

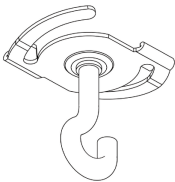

## Wire

2 x T95

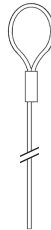

## Gripper

2 x 9-38E



For measurements and more information about the products please visit [www.alemtek.com](http://www.alemtek.com)

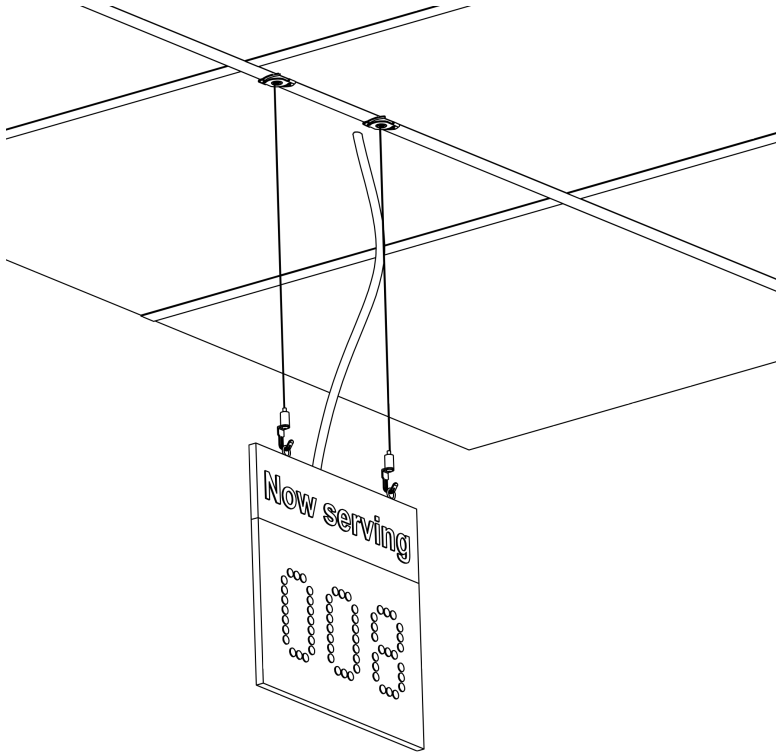

## Attachment

2 x 32SM5LX



## Wire

2 x T3



## Gripper

2 x 9-39J

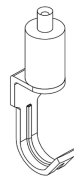

For measurements and more information about the products please visit [www.alemtek.com](http://www.alemtek.com)

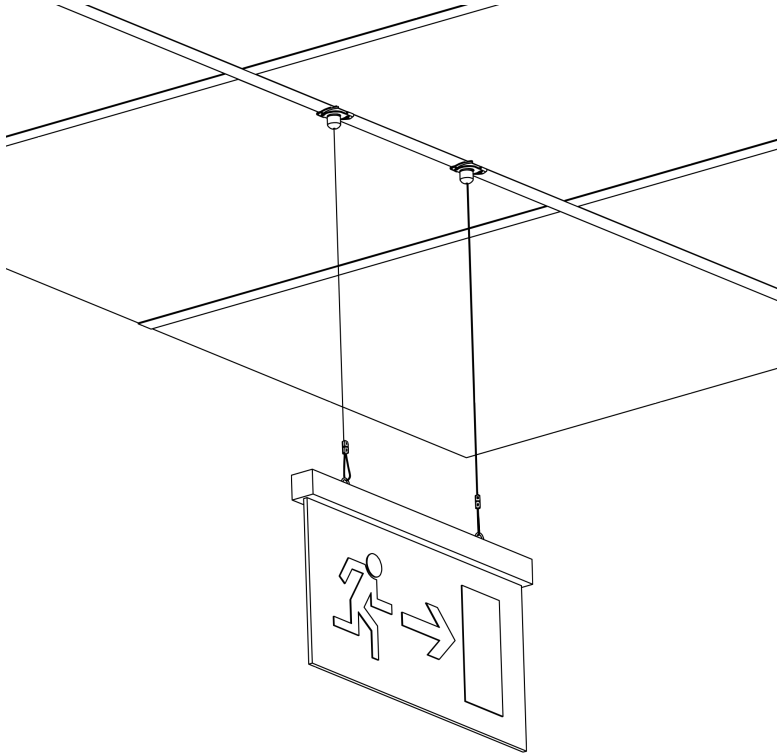

## Attachment

2 x 32SM5L5  
2 x 412MM12M5BL9  
2 x 411M12BL14H

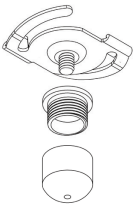

## Wire

2 x T2



## Gripper

2 x 7801

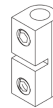

For measurements and more information about the products please visit [www.alemtek.com](http://www.alemtek.com)

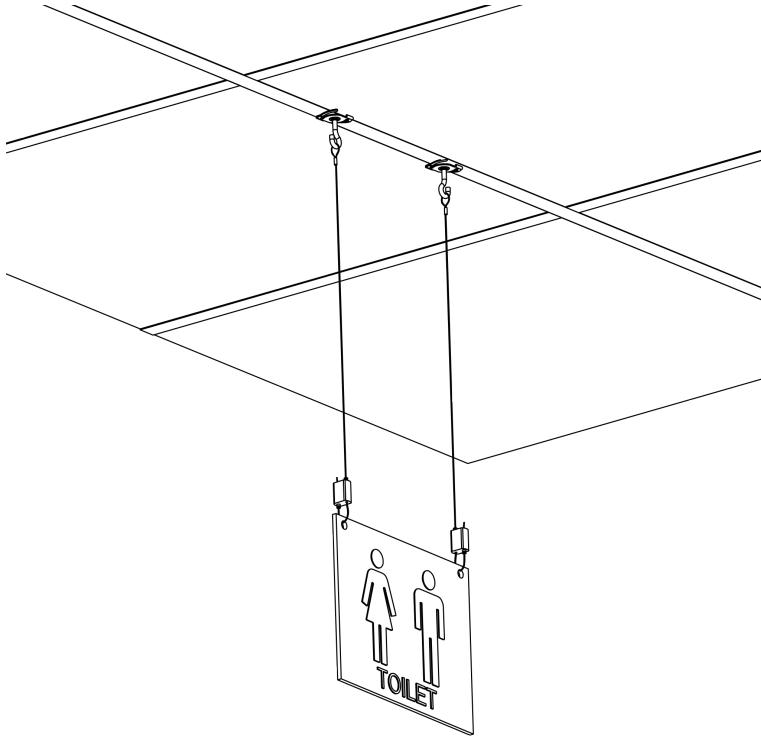

### Attachment

2 x 32SD4L30J

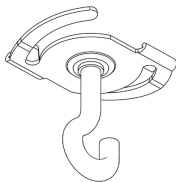

### Wire

2 x T95

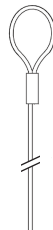

### Gripper

2 x 9-39UPDNW

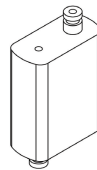

For measurements and more information about the products please visit [www.alemtek.com](http://www.alemtek.com)

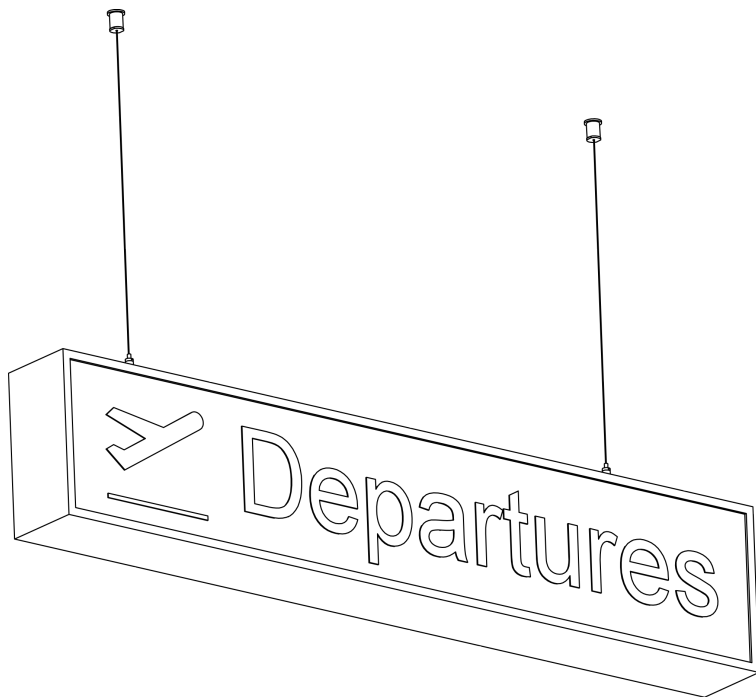

### Attachment

2 x 412M13M6BL20  
2 x 411MM13BL12

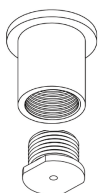

### Wire

2 x T2



### Gripper

2 x 9-38M4  
2 x 712MM4L8



For measurements and more information about the products please visit [www.alemtek.com](http://www.alemtek.com)

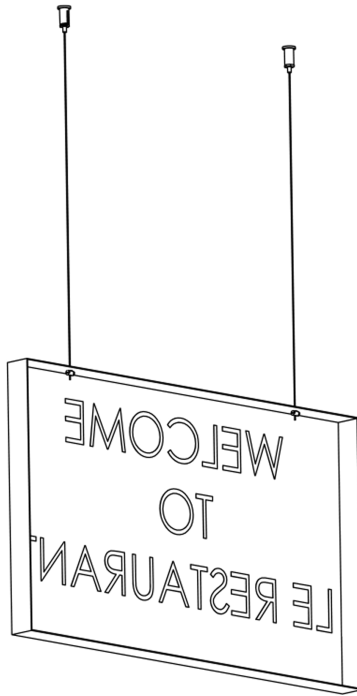

### Attachment

2 x 412M8M6BL20U  
2 x 9-13H

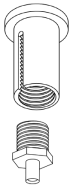

### Wire

2 x F



### Gripper

2 x 9-4401



For measurements and more information about the products please visit [www.alemtek.com](http://www.alemtek.com)

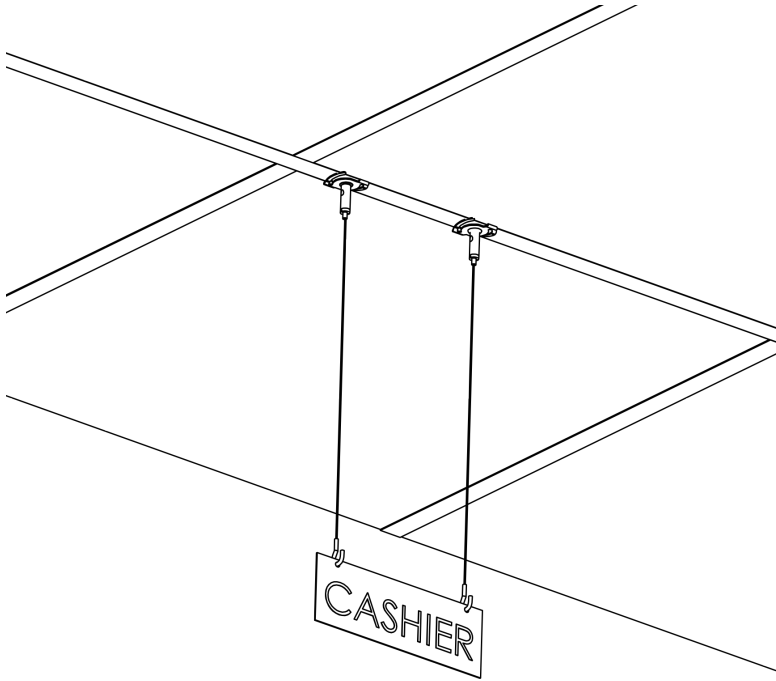

### Attachment

2 x 32SM5L5

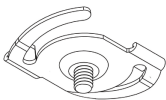

### Wire

2 x TJ



### Gripper

2 x 9-38M5



For measurements and more information about the products please visit [www.alemtek.com](http://www.alemtek.com)

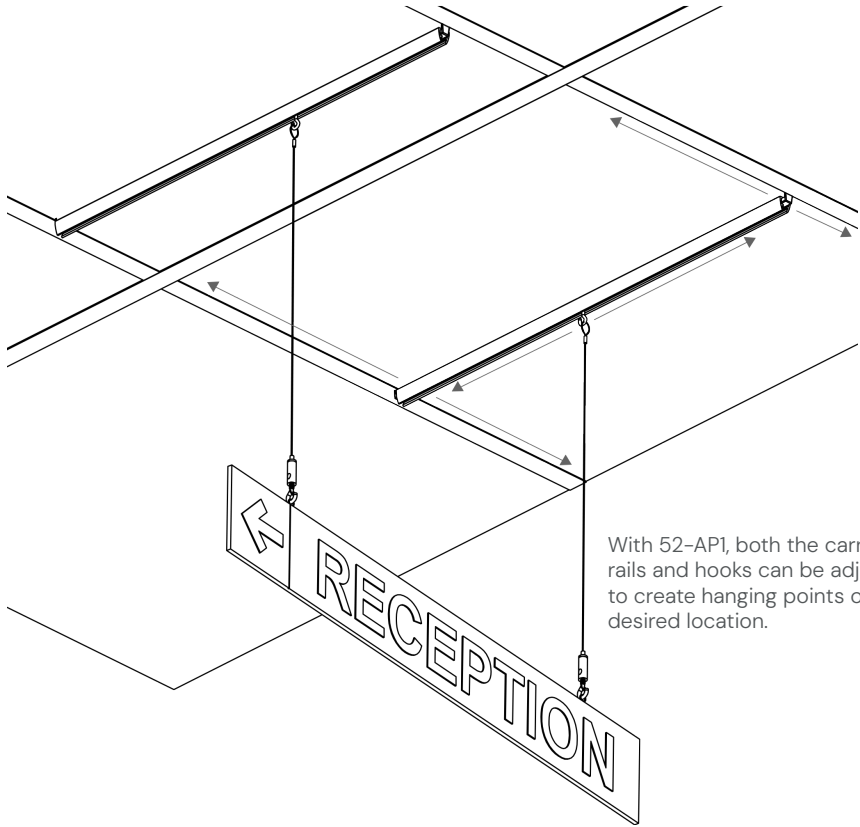

With 52-API, both the carrying rails and hooks can be adjusted to create hanging points on any desired location.

### Attachment

1 x 52-API

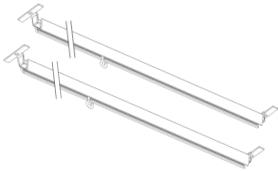

### Wire

2 x T95



### Gripper

2 x 9-38E

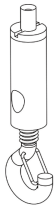

For measurements and more information about the products please visit [www.alemtek.com](http://www.alemtek.com)



To suspend an object from an angled position, use an attachment with a slit.

## Attachment

2 x 412MM12M5BL9  
2 x 411M12BL14U

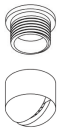

## Wire

2 x T7D5



## Gripper

2 x 7802



For measurements and more information about the products please visit [www.alemtek.com](http://www.alemtek.com)



### Wire

2 x T95

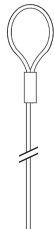

### Gripper

2 x 9-39UPDNW

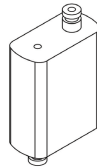

For measurements and more information about the products please visit [www.alemtek.com](http://www.alemtek.com)

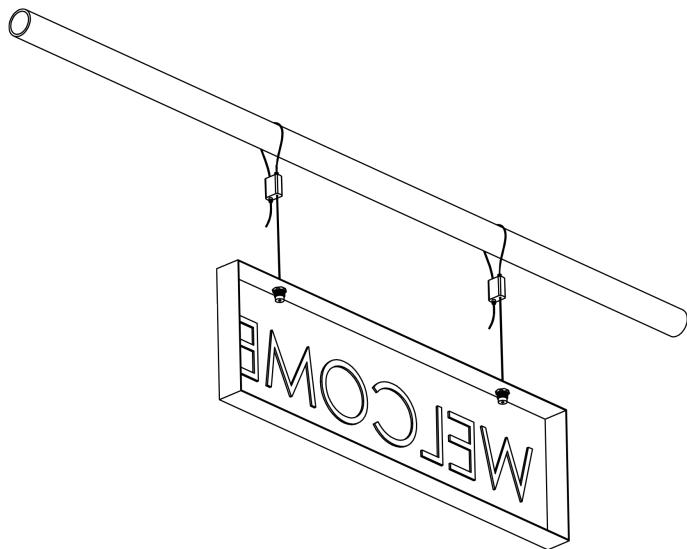

### Gripper

2 x 9-39UPDNW

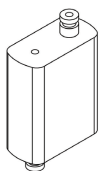

### Wire

2 x F



### Gripper

2 x 9-33MM10  
2 x 726M10P1

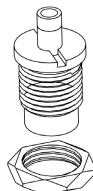

For measurements and more information about the products please visit [www.alemtek.com](http://www.alemtek.com)

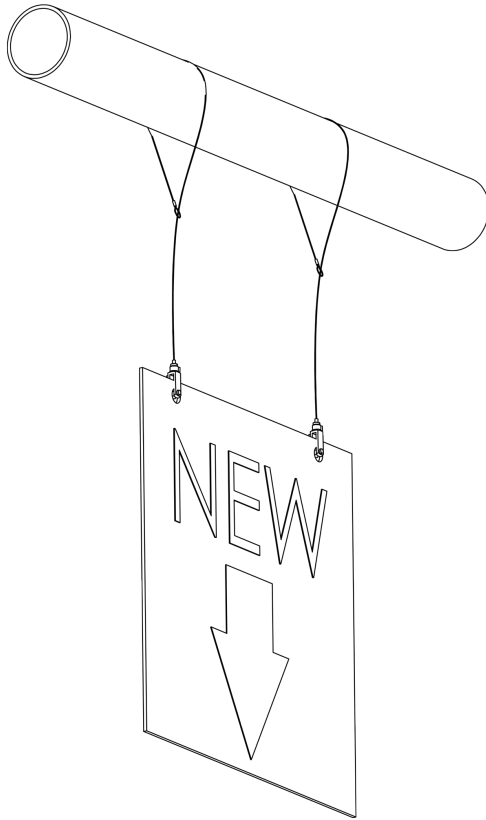

### Wire

2 x T95

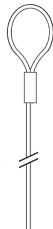

### Gripper

2 x 9-39U

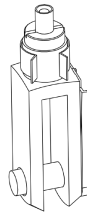

For measurements and more information about the products please visit [www.alemtek.com](http://www.alemtek.com)

# ALEMTEK

Emmabodavägen 4  
382 45 Nybro  
Sweden

Tel: +46 (0)481-696 60

[info@alemtek.com](mailto:info@alemtek.com)  
[www.alemtek.com](http://www.alemtek.com)

All information in this catalogue is without engagement, replaces all preceding information and can always be modified. We have the right to change at any time the technical aspects of our products without foregoing communication. No part of this catalogue may be copied without authorisation.

© Copyright 2025 Alemtek AB.